

Datasheet

Fiber delivery system accessory opto-mechanics - laserPLATE

Qioptiq has introduced a series of accessories for the kineFLEX™ range of laser to fiber couplers that now make fiber to laser alignment easier than ever. With the introduction of the laserPLATE™, users can now buy a complete mechanical mounting and packaging system for the Compass™, Sapphire™ and Cube™ range of OEM lasers from Coherent®. All optical and mechanical alignment and mounting considerations are resolved with the laserPLATE™ and users now only need take care of the fiber output to the application.

The system comprises a combined heatsink and chassis to house the laser; including pre-fitted dowels and fixings specifically positioned for the Compass™ DPSS, Sapphire™ OPSL and Cube™ diode lasers. Once the laser head is fixed in the chassis, the controller module is easily connected directly to the laser through an open access in the chassis. Finally a lid is provided to complete the laser housing.

The laserPLATE™ is only sold in conjunction with a kineFLEX™ fiber beam delivery system and is shipped already pre-fitted with the 4-axis fiber manipulator. Final laser to fiber alignment is then performed in the usual straightforward manner using the kineFLEX™ fiber beam delivery system.

Other OEM laser packaging solutions are available from Qioptiq. Please call for details.

Coherent®, Sapphire™, Compass™ and Cube™ are all trademarks of Coherent Inc.

Some of the product features include:

- Combined laser chassis and heatsink design
- Ease of integration and alignment
- Pre-fitted dowels and fixings for accurate positioning
- Opto-mechanically stable enclosure design
- Fully compatible with Qioptiq's kineFLEX™ range
- Integrated kineMATIX-P2™ manipulator



Technical Specifications

Product line		Units
Sapphire A		
Wavelength	488	nm
Power range	10 - 50	mW
Compatible models	488 LP	-
Compass A		
Wavelength	532, 561	nm
Power range	10 - 150	mW
Compatible models	215, 315, 561	-
Cube		
Wavelength	405, 445, 635, 660	nm
Power range	8 - 60	mW
Compatible models	405, 455, 635, 660	-

Note: OEM versions available please call

Sapphire

Order code: laserPLATE -

Product line: Compass, Cube, Sapphire

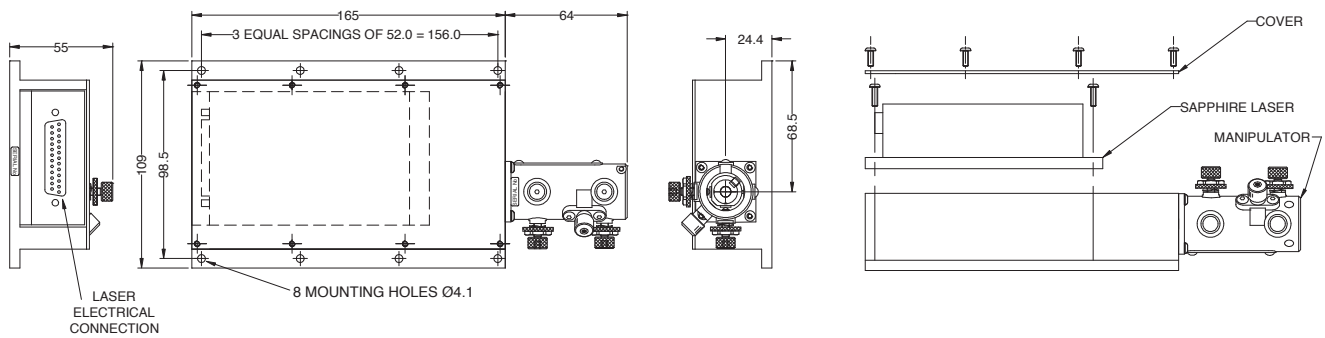

Compass

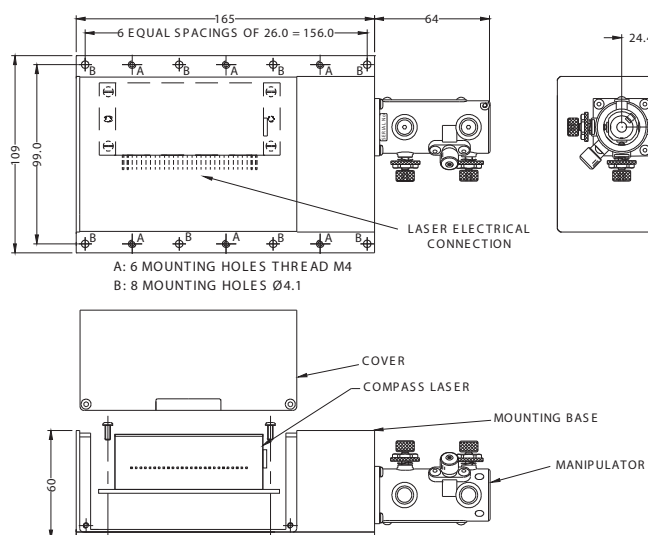

Cube

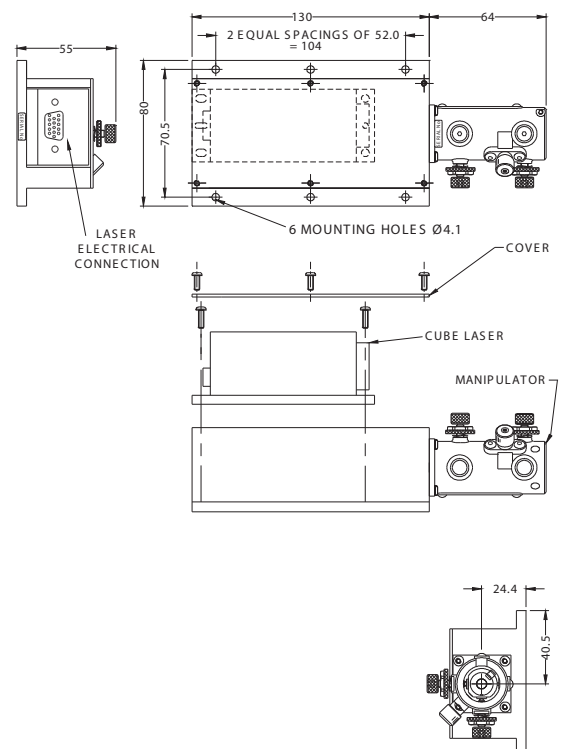

Fiber Optics



kineFLEX™

Robust laser beam delivery system for precision measurement applications

- Fiber coupling for DPSS, diode and gas lasers
- Highly repeatable and stable operation
- Greater than 65% coupling efficiency



kineFLEX-HPV™ / kineFLEX-UV™

Robust high power laser beam delivery system for precision measurement applications

- Input power up to 500mW for 488nm or higher
- Input power up to 20mW for 375nm
- OEM multiple wavelength versions available



kineFLEX-DUO™

Robust laser beam delivery system for two laser sources at visible wavelengths

- Efficient and simple beam combination
- Visible wavelengths
- Rugged platform for industrial applications

Lasers



iFLEX2000™

Extremely reliable and robust fiber coupled laser designed for volume manufacturing

- UV, Visible and NIR Wavelengths
- Integrated drive and temperature control electronics
- Modular singlemode fiber delivery system



iFLEX-Mustang™

Fiber coupled solid state laser with on-board acousto-optic modulation

- DPSS lasers, 488, 532 and 561nm
- High long term stability and low noise
- 25mW of output power



iFLEX-Q3™

Compact laser diode system for precision optical instrumentation

- Exceptional brightness, stability and long-term reliability
- Highly polarized beam
- Versatile, small form laser head and remote electronics module

Multi-laser Engines

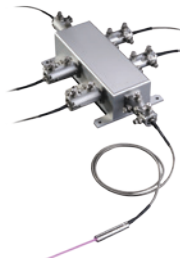

iFLEX-Adder™

5 into 1 fiber-coupled laser beam combination system

- True 'Plug & Play' capability enabling ultimate flexibility of laser suite
- Upgradeable from 2 to 5 wavelengths as required
- Compatible with kineFLEX™ and kineFLEX-HPV™



iFLEX-Viper™

The world's first integrated Multi-laser Engine

- Combines 5 wavelengths in one instrument
- Delivers wavelengths via a singlemode fiber optic cable
- On-board acousto-optic modulation up to 3MHz

For further information please contact:

Mitchell Point, Ensign Way, Hamble, Hampshire, SO31 4RF
Email: sales@qpl.qioptiq.com
Tel: +44 (0) 23 80 744 500 Fax: +44 (0) 23 80 744 501
www.qioptiq.com



www.qioptiq.com/diode-lasers
www.qioptiq.com/fiber-optics

laserPLATE™ is a trademark of Qioptiq Photonics Ltd. Copyright ©2011 Qioptiq Photonics Ltd.
Qioptiq Photonics Ltd. follows a policy of continuous improvement. Specifications are subject to change without notification.