



Albrighter Technology Co., Limited

Address: No.16 Building 4, Shangjiang Garden, Hebei District, Tianjin China

Website: <https://www.albrighter.com> Email: info@albrighter.com

Optical window is two mutually parallel surfaces of the optical glass after grinding and polishing. They are usually used as electronic sensors, optical lens, laser processing head protection device. In selecting the window, the transmission characteristics and mechanical properties of the material should be considered in line with your application.

Coated or uncoated windows could be provided. The size can be designed according to customer's requirements.

Material:	BK7
Diameter Tolerance:	+0/-0.1mm
Thickness Tolerance:	±0.1mm
Flatness:	$\lambda/4$ @ 633mm
Surface Quality:	40/20-60/40
Parallelism:	< 1 arc min.
Bevel:	0.2-0.4mm x 45°
Coatings:	uncoated or as requests

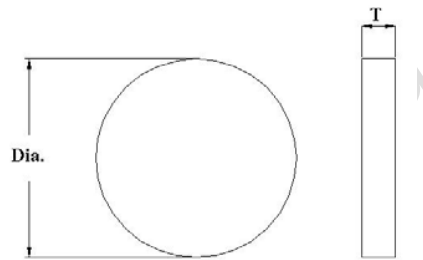

AW01-BK7 windows mirror

CAT.	Dia or HxL(mm)	T(mm)
AW01-005	5	2
AW01-009	9	2
AW01-010	10	2
AW01-012	12.7	2
AW01-020	20	2
AW01-025	25 or 25.4	4
AW01-030	30	4
AW01-040	40	4
AW01-050	50	4
AW01-055	55	1.7
AW01-075	75	4
AW01-010-010	10x10	2
AW01-020-020	20x20	3
AW01-050-050	50x50	4
AW01-075-075	75x75	4

***All models can't be totally listed. Other demand, please send us required spec details.**

***In addition to N-BK7, we could also supply CaF₂, Fused Silica, ZnSe, Ge substrate windows with customized size and coatings available.**