



# DATASHEET



## FEATURES

- ✓ Collimated Beam
- ✓ Aspherical Glass Lens
- ✓ Small Black Anodized Aluminum Package

## APPLICATIONS

- ✓ Measurement
- ✓ Automation
- ✓ Alignment

## Operational Hazard of Laser Module

This laser module emits radiation that is visible/invisible and harmful to human eye. When in use, do not look directly into the laser emitting aperture. Direct viewing of laser diode emission at close range may cause eye damage.



## Limited Warranty

Laser diodes have long life time when operated within specs. No warranty coverage for modifications, or damage due to misapplication/ESD failure.



## SPECIFICATIONS

### OPTICAL

Wavelength	785+/- 5 nm
Optical Output Power	70 mW
Beam Shape	Elliptical, Collimated
Beam Size (near exit)	5mm X 2mm
Wavelength Drift	0.2nm/°C
Laser Structure	Single Mode Laser
Polarization Orientation	Long Axis
Divergence (at collimation)	< 1 mrad

### ELECTRICAL

Operating Voltage	2 V DC
Operating Current	100 mA
Maximum Operating Current	140 mA
Monitoring PD Current	0.25 mA (typical)

### MECHANICAL/ENVIRONMENTAL

Dimension, mm	8mm (D)X 12.8 mm (L)
Operating Temperature	+10°C to +60°C
Storage Temperature	-40°C to +80°C

**Notes:** Collimated laser diode is sold solely for use in OEM equipment. OEM is responsible for compliance with all applicable safety regulations.

Other infrared diodes are available on request.

## OUTLINE DRAWING

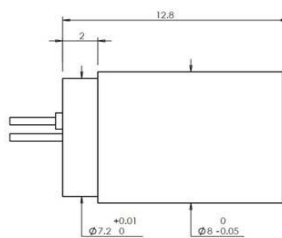

### Pin Connection

