



POLYtek™ Series

Variable Configuration

Polygon Scan Heads

for High Power Applications

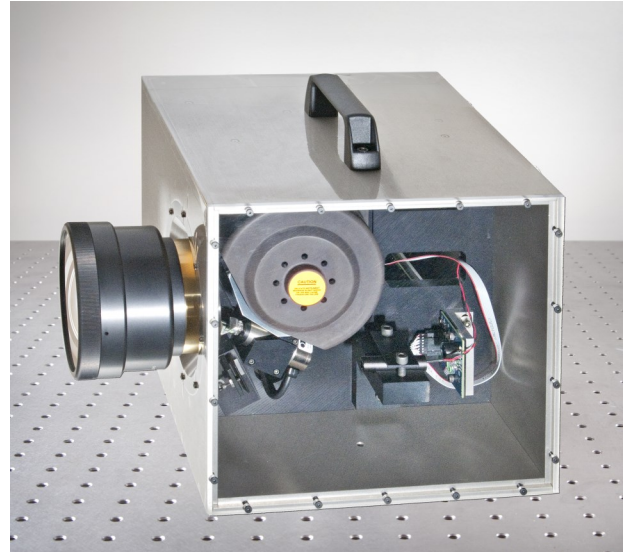

POLYtek™ family of Polygon Scan Heads from Lincoln Laser offers a variety of configurations for many different applications providing POLYGON speeds of hundreds of meters / second.

Offered at a competitive price, the POLYtek™ is developed for ULTRAFAST PS & FS lasers as well as high power lasers used in thin film, raster scan and micromachining at high removal rates while providing low surface roughness.

APPLICATIONS

- Competitive cost design with high speed performance
- Good choice for continuous scans such as web applications
- Ideal solution for coordinate measuring machines and geometry inspection
- Excellent scan head for aircraft and automotive component and finished unit inspection
- Ultimate solution for automated measurement and examination for electronics, medical and aerospace
- Preferred choice for power train and sheet metal inspection as well as robotics and other optical applications

Very high scan rates up to 300 m/s	Provides scan rates for current and leading edge scanning applications
Provides line scanning and slow axis indexing	Optimal scanning efficiency while offering application versatility
Raster based data input	Industry standard input format for fast & easy start up with minimal costs
Available with optical error correction	Geometric polygon errors corrected via galvanometer step movement
Optional galvanometer	Provides optimal scan positioning flexibility with faster motion
Facet angular offset and f theta distortions in the slow axis easily resolved	Uses current commercial marking software through the lens configuration files already in use

SPECIFICATIONS	
Input Aperture	15mm
Standard Wavelengths	355nm, 532nm, 1064nm
Scan Speed	150—1600 lines per second 0—1600 lines per second optional
Galvanometer Analog Communication	+/- 10 volts
Input Power	+/- 15 volts DC @ 7 amps maximum
Line Placement Repeatability—Y axis	+/- 48 microrad
Pixel Placement Repeatability—X axis	0.10 microrad
Output Scan Angle	Maximum +/- 16 degrees for X and Y Axis
Dimensions (excluding handles & scan lens)	10 inches x 12 inches x 12 inches
Operating Temperature	25 +/- 10 degrees C
Start of Line Sensor	YES
Port for CDA purge	YES
Control Card	YES, included with software interface
Provides fastest X axis scans over moving targets. With Galvo option provides fastest X—Y scans.	

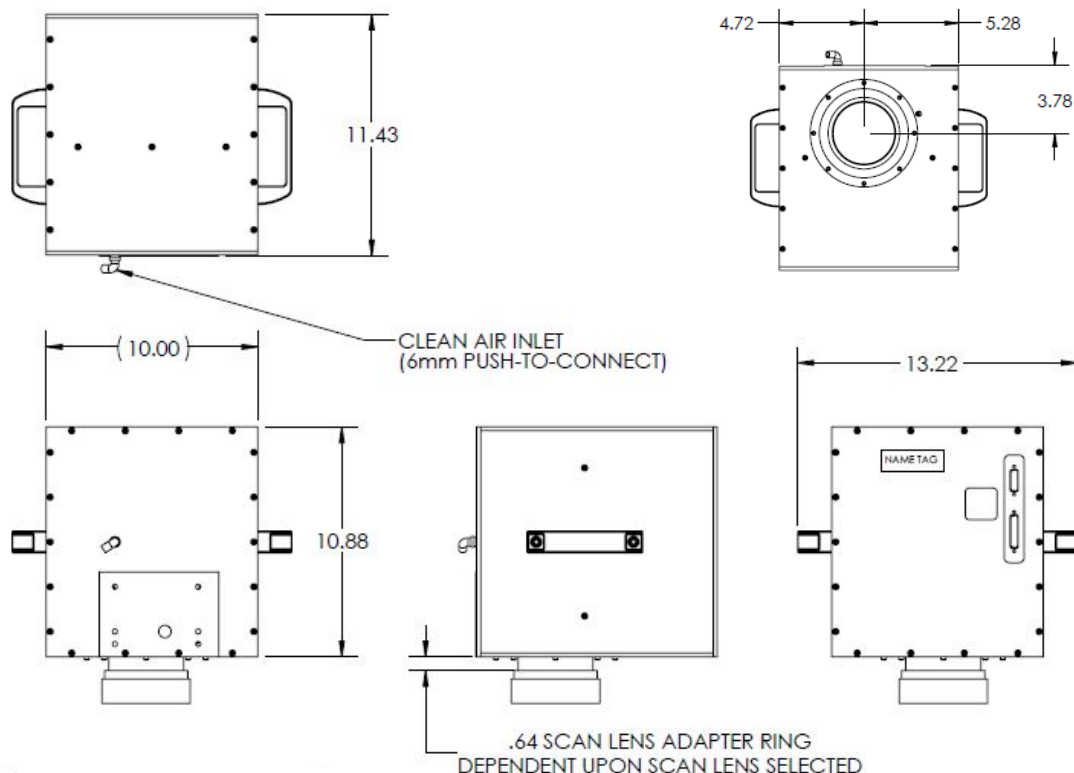

Lincoln Laser Company is an Engineering and Manufacturing Company. The company specializes in high precision laser systems and optical components. Our products can be found in a broad variety of industries ranging from food inspection to the biotech and semi-conductor industry. Located in Phoenix, Arizona, Lincoln Laser Company is the manufacturer of choice for many well-known companies around the globe. For more information, please visit our website at www.lincolnlaser.com.