



Home About Us Products Purchase Guide Capacity

Stocks Download

News

Contact Us

Site map | (en_sitemap.asp) China | (index.: (en_index.asp) (en_list.asp?dh=gywm) (en_list.asp?dh=gxyj) (en_list.asp?dh=cgzn) (en_list.asp?dh=scnl) (en_stock.asp) (en_index.asp) (en_list.asp?dh=xzzx) (en_list.asp?dh=gsde) 86-0431-86781966 (en_list.asp?dh=lxwm)

Current location: Home (en_index.asp)> Products (en_list.asp?dh=gxyj)> Spherical lenses (en_list.asp?dh=gxyj&classid=4) > Plano-convex spherical lenses (en_list.asp?

roducts

- Spherical lenses (en_list.asp?dh=gxyj&classid=4)
- Ball lenses (en_list.asp?dh=gxyj&classid=6)
- Cylindrical lenses (en_list.asp?dh=gxyj&classid=5)
- Rod lenses (en_list.asp?dh=gxyj&classid=7)
- Windows(Optical flat) (en_list.asp?dh=gxyj&classid=7)

Plano-convex spherical lenses

dh=gxyj&classid=4&classid2=4)

Lenses have many application ranging from the simple collection of the scanning of laser beams to precise imaging and image transfer.Plano-Convex Lenses are the best choice for focusing parallel rays of light to a single point.This lens can be used to focus, collect and collimate light. It is the most economical choice for demanding applications.

Filters (en_list.asp?dh=gxyj&classid=8)

Prisms (en_list.asp?dh=gxyj&classid=9)

Grating (en_list.asp?dh=gxyj&classid=11)

Coating (en_list.asp?dh=gxyj&classid=12)

IR lenses (en_list.asp?

dh=gxyj&classid=13)
UV lenses (en_list.asp?

dh=gxyj&classid=15)
VIS lenses (en_list.asp?

dh=gxyj&classid=16)
OEM element (en_list.asp?

dh=gxyj&classid=14)
Assembly (en_list.asp?

dh=gxyj&classid=17)
Optical glasses (en_list.asp?

dh=gxyj&classid=18)
Optical crystal (en_list.asp?

dh=gxyj&classid=19)

Atoptical Co.,Ltd. provides these lenses with the material of BK7, fused silica ,Si,Ge,CaF2, or other optical glass and crystal ect..

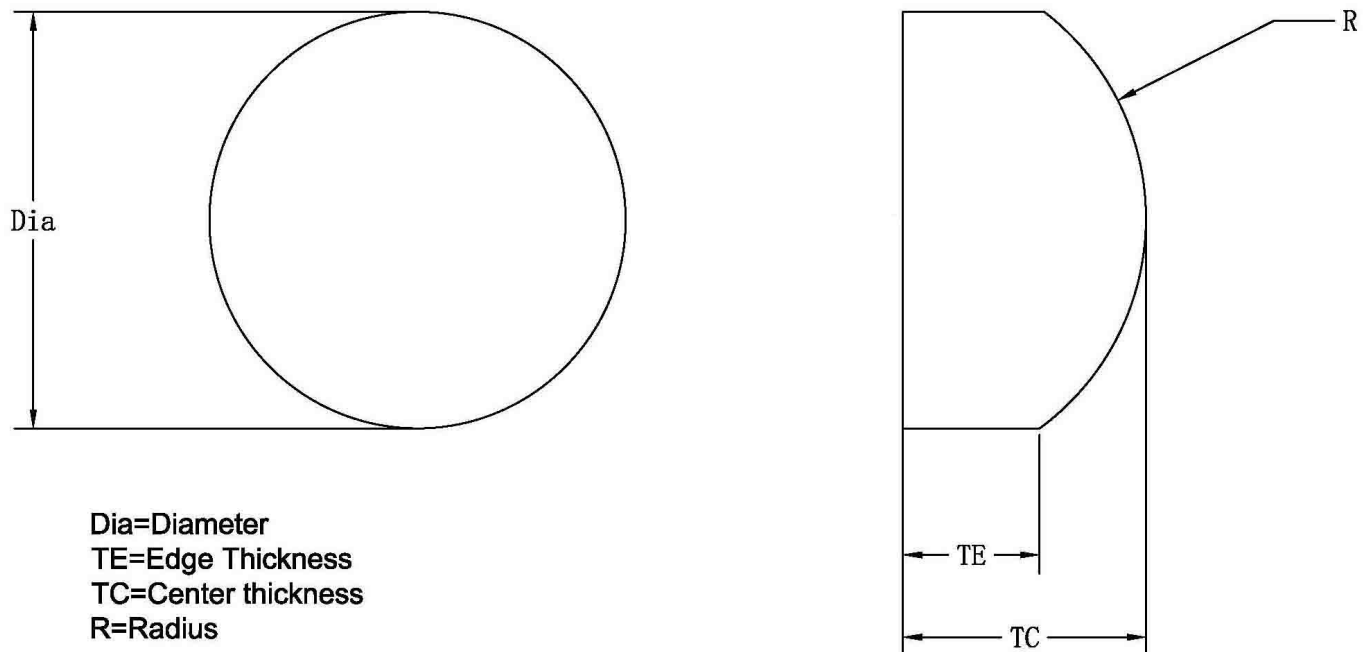

Specifications	Normal	High Precision	Mfg. Limit
Material :	H-K9L	H-K9L	H-K9L
Design Index :	1.5168	1.5168	1.5168
Diameter Tolerance :	+0/-0.1mm	+0/-0.05mm	+0/-0.01mm



(en_list.asp?dh=lxwm)



(en_list.asp?dh=gxyj)

Thickness Tolerance :	+/-0.1mm	+/-0.05mm	+/-0.01mm
Focal Length Tolerance :	+/-2%	+/-1%	+/-0.5%
Centeration :	3 arc min	1 arc min	30 arc sec
Surface Quality :	60-40	40-20	10-5
Surface Figure :	3 lambda	2 lambda	1 lambda
Surface Irregularity :	1 lambda	1/5 lambda 1	1/10 lambda
Clear Aperture :	>80%	>90%	100%
Bevel :	+/-0.2*45 degree	+/-0.1*45 degree	+/-0.05*45degree

Other materials are also available.

AR coating is available upon request.

[Home](#) [About Us](#) [Products](#) [Purchase Guide](#) [Capacity](#) [Stocks](#) [Download](#) [News](#) [Contact Us](#)
 (index.asp) (en_list.asp?dh=gywm) (en_list.asp?dh=gxyj) (en_list.asp?dh=cgzn)
 (en_list.asp?dh=scnl) (en_stock.asp) (en_list.asp?dh=xzzx) (en_list.asp?dh=gsdt)
 (en_list.asp?dh=lxwm)

URL:<http://www.atoptical.com> (<http://www.atoptical.com>)

Mailbox:info@atoptical.com (<mailto:info@atoptical.com>)

Telephone:+ 86-431-86887866

QQ:12237636 (<http://wpa.qq.com/msgrd?v=3&uin=12237636&site=qq&menu=yes>)



Copyright @ Changchun Jatko technology co ltd Technical support: guangshang science and technology