

Current location: [Home \(en_index.asp\)](#)> [Products \(en_list.asp?dh=gxyj\)](#)> [Spherical lenses \(en_list.asp?dh=gxyj&classid=4\)](#) > [Plano-convex spherical lenses \(en_list.a](#)

Products

- Spherical lenses ([en_list.asp?](#)
- [dh=gxyj&classid=4](#))
Ball lenses ([en_list.asp?](#)
- [dh=gxyj&classid=6](#))
Cylindrical lenses ([en_list.asp?](#)
- [dh=gxyj&classid=5](#))
Rod lenses ([en_list.asp?](#)
- [dh=gxyj&classid=7](#))
Windows(Optical flat) ([en_list.asp?](#)
- [dh=gxyj&classid=8](#))
Filters ([en_list.asp?dh=gxyj&classid=10](#))
- Prisms ([en_list.asp?dh=gxyj&classid=9](#))
- Grating ([en_list.asp?dh=gxyj&classid=11](#))
- Coating ([en_list.asp?dh=gxyj&classid=12](#))
- IR lenses ([en_list.asp?](#)
- [dh=gxyj&classid=13](#))
UV lenses ([en_list.asp?](#)
- [dh=gxyj&classid=15](#))
VIS lenses ([en_list.asp?](#)
- [dh=gxyj&classid=16](#))
OEM element ([en_list.asp?](#)
- [dh=gxyj&classid=14](#))
Assembly ([en_list.asp?](#)
- [dh=gxyj&classid=17](#))
Optical glasses ([en_list.asp?](#)
- [dh=gxyj&classid=18](#))
Optical crystal ([en_list.asp?](#)

Plano-convex spherical lenses

[dh=gxyj&classid=4&classid2](#)

Lenses have many application ranging from the simple collection of the scanning of laser beams to precise imaging and image transfer.Plano-Convex Lenses are the best choice for focusing parallel rays of light to a single point.This lens can be used to focus, collect and collimate light. It is the most economical choice for demanding applications.

Atoptical Co.,Ltd. provides these lenses with the material of BK7, fused silica ,Si,Ge,CaF2, or other optical glass and crystal ect..

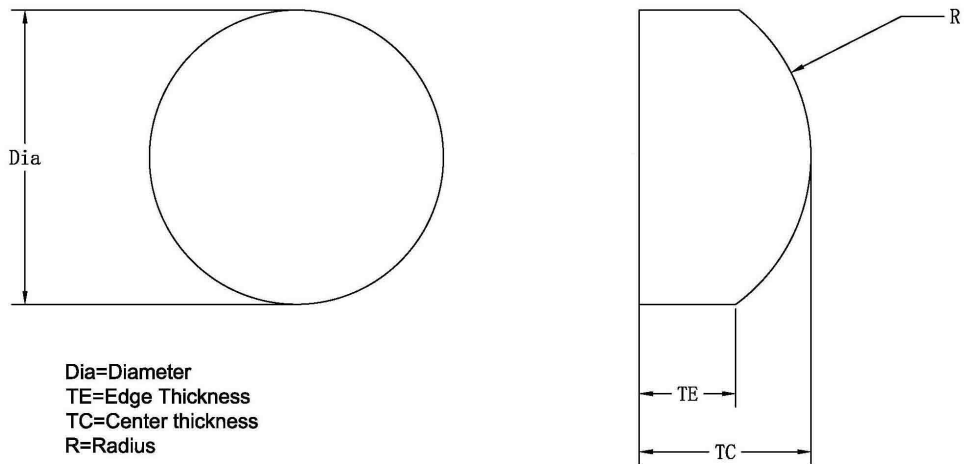

Specifications	Normal	High Precision	Mfg. Limit
Material :	H-K9L	H-K9L	H-K9L
Design Index :	1.5168	1.5168	1.5168
Diameter Tolerance :	+0/-0.1mm	+0/-0.05mm	+0/-0.01mm
Thickness Tolerance :	+/-0.1mm	+/-0.05mm	+/-0.01mm
Focal Length Tolerance :	+/-2%	+/-1%	+/-0.5%
Centeration :	3 arc min	1 arc min	30 arc sec



(en_list.asp?dh=lxwm)

Surface Quality :	60-40	40-20	10-5
Surface Figure :	3 lambda	2 lambda	1 lambda
Surface Irregularity :	1 lambda	1/5 lambda	1/10 lambda
Clear Aperture :	>80%	>90%	100%
Bevel :	+/-0. 2*45 degree	+/-0. 1*45 degree	+/-0. 05*45degree



(en_list.asp?dh=gxyj)

Other materials are also available.

AR coating is available upon request.

[Home](#)

[About Us](#)

[Products](#)

[Purchase Guide](#)

[Capacity](#)

[\(index.asp\)](#) [\(en_list.asp?dh=gywm\)](#) [\(en_list.asp?dh=gxyj\)](#) [\(en_list.asp?dh=cgzn\)](#)

[\(en_list.asp?dh=scnl\)](#) [\(en_stock.asp\)](#) [\(en_list.asp?](#)

[dh=zzzx\)](#) [\(en_list.asp?dh=gsdt\)](#)

[\(en_list.asp?dh=lxwm\)](#)

[Stocks](#)

[Download](#)

[News](#)

[Contact Us](#)

URL:<http://www.atoptical.com> (<http://www.atoptical.com>)

Mailbox:info@atoptical.com (<mailto:info@atoptical.com>)

Telephone: +86-431-86887866

QQ:12237636 (<http://wpa.qq.com/msgrd?v=3&uin=12237636&site=qq&menu=yes>)



Copyright @ Changchun Jatko technology co ltd Technical support: guangshang science and technology