

Current location: Home (en_index.asp) > Products (en_list.asp?dh=gxyj) > Spherical lenses (en_list.asp?dh=gxyj&classid=4) > Plano-concave spherical lenses (en_list.a

Products

- Spherical lenses (en_list.asp?dh=gxyj&classid=4)
 - Ball lenses (en_list.asp?dh=gxyj&classid=6)
 - Cylindrical lenses (en_list.asp?dh=gxyj&classid=5)
 - Rod lenses (en_list.asp?dh=gxyj&classid=7)
 - Windows(Optical flat) (en_list.asp?dh=gxyj&classid=8)
 - Filters (en_list.asp?dh=gxyj&classid=10)
- Prisms (en_list.asp?dh=gxyj&classid=9)
- Grating (en_list.asp?dh=gxyj&classid=11)
- Coating (en_list.asp?dh=gxyj&classid=12)
- IR lenses (en_list.asp?dh=gxyj&classid=13)
- UV lenses (en_list.asp?dh=gxyj&classid=15)
- VIS lenses (en_list.asp?dh=gxyj&classid=16)
- OEM element (en_list.asp?dh=gxyj&classid=14)
- Assembly (en_list.asp?dh=gxyj&classid=17)
- Optical glasses (en_list.asp?dh=gxyj&classid=18)
- Optical crystal (en_list.asp?dh=gxyj&classid=19)

Plano-concave spherical lenses

dh=gxyj&classid=4&classid2

Plano-Concave Lenses are the best choice where object and image are at absolute conjugate ratios greater than 5:1 and less than 1:5 to reduce spherical. Plano-Concave lenses bend parallel input rays so they diverge from one another on the output side of the lens and hence have a negative focal length. The spherical aberration of the Plano-Concave lenses is negative and can be used to balance aberrations created by other lenses. Similar to the Plano-Convex lenses, the curvature surface should face the larger object distance or the infinite conjugate (except when used with high-energy lasers where this should be reversed to eliminate the possibility of a virtual focus) to minimize spherical aberration. Atoptical provides these lenses with the material of BK7, fused silica, Si, Ge, CaF2, or other optical glass and crystal ect..

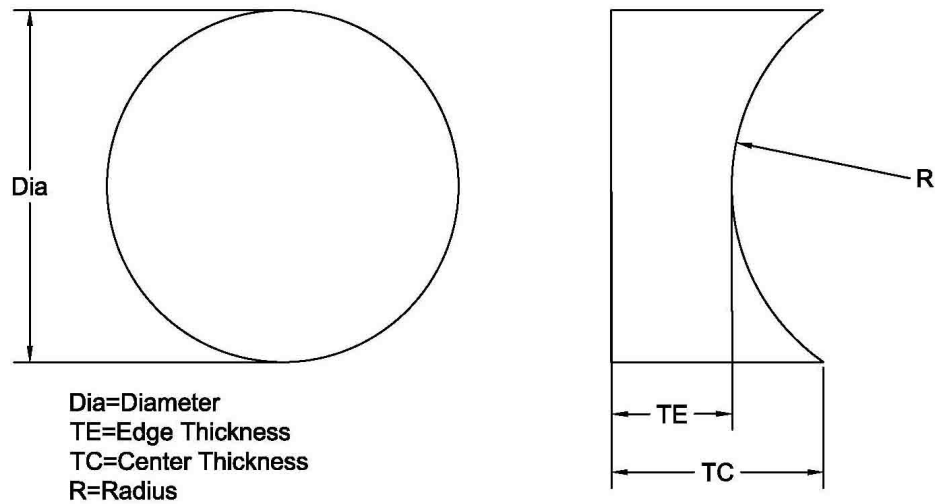

Specifications	Normal	High Precision	Mfg. Limit
Material :	N-BK7	N-BK7	N-BK7
Design Index:	1.5168	1.5168	1.5168
Diameter Tolerance :	+0/-0.1mm	+0/-0.05mm	+0/-0.02mm
Thickness Tolerance :	+/-0.1mm	+/-0.05mm	+/-0.01mm



(en_list.asp?dh=lxwm)



(en_list.asp?dh=gxyj)

Focal Length Tolerance:	+/-2%	+/-1%	+/-0.5%
Centeration:	3 arc min	1 arc min	30 arc sec
Surface Quality:	60-40	40-20	10-5
Surface Figure:	3 lambda	2 lambda	1 lambda
Surface Irregularity:	1 lambda	1/5 lambda	1/10 lambda
Clear Aperture:	>80%	>90%	100%
Bevel:	+/-0.2mm*45 deg	+/-0.1mm*45 deg	+/-0.05mm*45 deg

Other materials are also available.

AR coating is available upon request.

- [Home](#)
- [About Us](#)
- [Products](#)
- [Purchase Guide](#)
- [Capacity](#)
- [Stocks](#)
- [Download](#)
- [News](#)
- [Contact Us](#)

URL:<http://www.atoptical.com> (<http://www.atoptical.com>)

Mailbox:info@atoptical.com (<mailto:info@atoptical.com>)

Telephone: +86-431-86887866

QQ:12237636 (<http://wpa.qq.com/msgrd?v=3&uin=12237636&site=qq&menu=yes>)



Copyright @ Changchun Jatko technology co ltd Technical support: guangshang science and technology