

NOTES:

1. LAST DASH NO. "XXX" INDICATES MICRON SIZE OF SLIT
Ex. HP-SLIT-3/8-DISC-XX-200 -INDICATES 200 MICRON THRU HOLE
2. "XX" INDICATES MATERIAL.
Ex. HP-SLIT-3/8-DISC-CU-XXX -INDICATES COPPER AS MATERIAL
3. REFER TO SPECIFICATIONS CHART

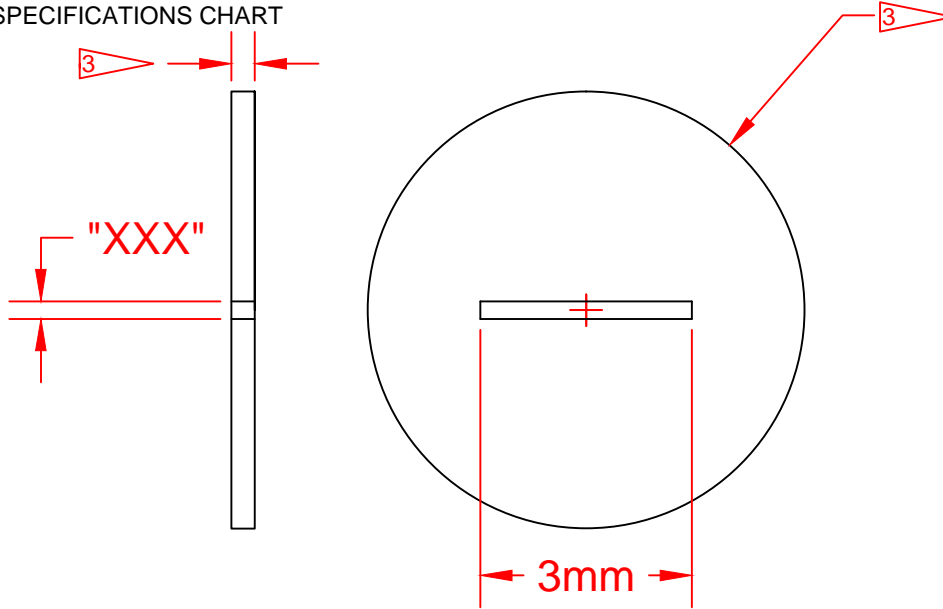

REV	DESCRIPTION	INCORP BY	DATE

MATERIAL "XX" SPECIFICATIONS

MATERIAL	MOLY PER ASTM B386	TUNGSTEN PER ASTM B760	110 COPPER PER ASTM B152 (BLACKENED ON ONE SIDE)	110 COPPER PER ASTM B152 (GOLD-PLATED ONE SIDE, BLACKENED ON THE OTHER)	CERAMIC					
DESIGNATION	MLY	TUN	CU	AU	CER					
DIAMETER	9.5mm +0.025 / -0.050mm (0.374in +0.000984 / -0.00197in)	9.5mm +0.025 / -0.050mm (0.374in +0.000984 / -0.00197in)	9.5mm +0.025 / -0.050mm (0.374in +0.000984 / -0.00197in)	9.5mm +0.025 / -0.050mm (0.374in +0.000984 / -0.00197in)	9.5mm +0.025 / -0.050mm (0.374in +0.000984 / -0.00197in)					
THICKNESS	0.013 - 0.025mm (0.000512 - 0.000984in)	0.025 - 0.050mm (0.000984 - 0.00197in)	0.018 - 0.025mm (0.000709 - 0.000984in)	0.025 - 0.050mm (0.000984 - 0.00197in)	0.125 - 0.250mm (0.00492 - 0.00984in)					
CENTERING	±0.125mm (±0.00492in)	±0.125mm (±0.00492in)	±0.125mm (±0.00492in)	±0.125mm (±0.00492in)	±0.125mm (±0.00492in)					
SLIT WIDTH TOLERANCES	Width	Tolerance +/-	Width	Tolerance +/-	Width	Tolerance +/-	Width	Tolerance +/-	Width	Tolerance +/-
	5µ	20%	5µ	20%	5µ	20%	5µ	20%	5µ	20%
	10 - 100µ	10%	10 - 100µ	10%	10 - 100µ	10%	10 - 100µ	10%	10 - 100µ	10%
	150 - 1000µ	5%	150 - 1000µ	5%	150 - 1000µ	5%	150 - 1000µ	5%	150 - 1000µ	5%

THIS DOCUMENT CONTAINS INFORMATION THAT IS CONFIDENTIAL AND PROPRIETARY TO LENOX LASER. THIS DOCUMENT IS FURNISHED ON THE UNDERSTANDING THAT THE DOCUMENT AND THE INFORMATION IT CONTAINS WILL NOT BE COPIED OR DISCLOSED TO OTHERS EXCEPT WITH THE WRITTEN CONSENT OF LENOX LASER. WILL NOT BE USED FOR ANY PURPOSE OTHER THAN CONDUCTING BUSINESS WITH LENOX LASER, AND WILL BE RETURNED AND ALL FURTHER USE DISCONTINUED UPON REQUEST BY LENOX LASER.

UNLESS OTHERWISE SPECIFIED ALL DIMENSIONS ARE IN INCHES
DECIMAL VALUES ARE SHOWN WITH DECIMAL TOLERANCE VALUES
DECIMAL .X = ±.1 TOLERANCES APPLIED TO THE PRINT
.XX = ±.01
IN THE .XXX = ±.005
PRINT .XXXX = ±.0005
FRACTIONAL AND ANGULAR VALUES ARE SHOWN WITH FRACTIONAL OR ANGULAR TOLERANCE VALUES.
FRACTIONS = ± 1/16
ANGLES = ± 1°

Material
REFER TO CHART



Drawing Number
A HP-SLIT-3/8-DISC-XX-XXX

REV
-

Used On
-

APPROVALS	DATE
DRAWN C. DRAPER	1/6/2016
CHK J. SCHUSTER	2/10/2016
ENGR J. SCHUSTER	2/10/2016
SHEET: 1 OF 1	DO NOT SCALE

Drawing Name
HIGH POWER SLIT