



Machine Vision Microscope



- Powerful Plug-and-Play USB – Imaging Module
- Steering- and Measurement Software included
- Integrated coaxial and ring light illumination (optionally)
- Perfectly optimized image through a closed optimized design
- One Wire Concept – one wire to the module
- Robust Aluminium block with multiple mounting options

Specification

IM•compact M ECO

Integrated Coaxial Illumination white

Steering- and Measurement Software included

Integrated Ring light white

USB 3.1 Type C Connector

FoV mm	WD mm	Resolution LP/mm	Measurement Resolution μm / pixel	Image	Frames / sec	Sensor	IM•compact M
3.8 x 2.8 mm	31	270	1.8	monochrome	55	Sony IMX265	IC-4351701UBE
3.8 x 2.8 mm	31	270	1.8	color	55	Sony IMX265	IC-4351701UCE
4.5 x 3.8 mm	31	270	1.8	monochrome	36	Sony IMX264	IC-4352701UBE
4.5 x 3.8 mm	31	270	1.8	color	36	Sony IMX264	IC-4352701UCE

Size: 70 x 150 x 40mm Weight: 0.5 kg

CE / RoHS / WEEE-Reg.-No. DE 68564667



Technical Drawing

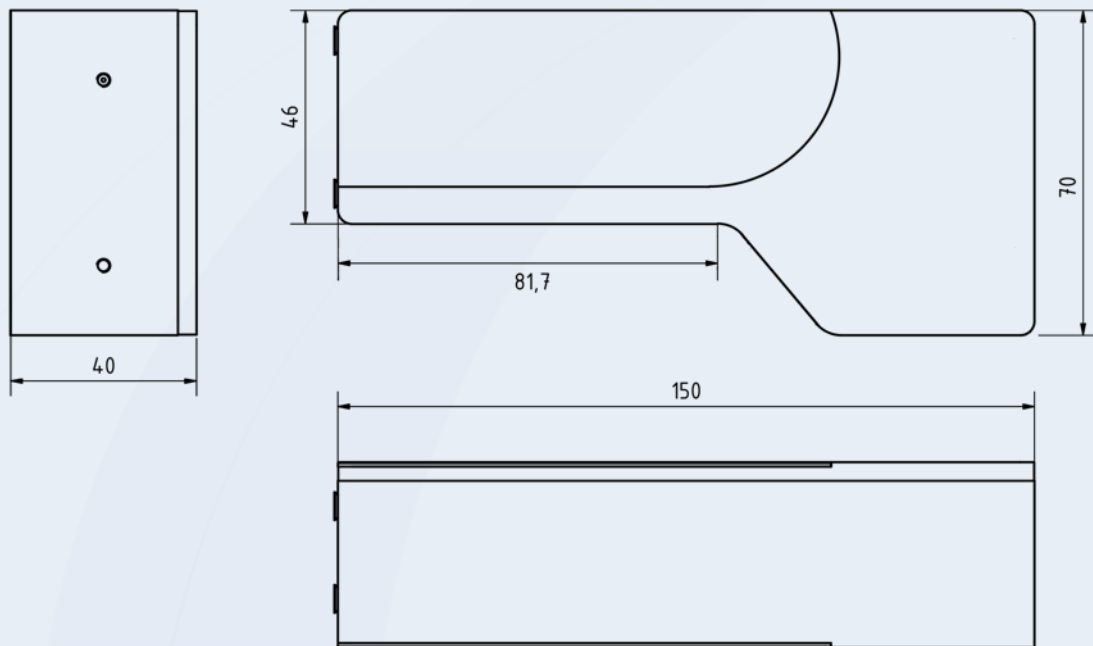

Sensor

Sony Pregius sensor IMX264

- Optimized Sony CMOS pixel: 3,45 μm
- High-resolution global-shutter sensor: 2456 x 2054 (5,04 MP)
- Compact 2/3" area sensor
- Framerate: 36 fps
- AOI

Sony Pregius sensor IMX265

- 1/1.8" area sensor with a pixel size of 3,45 μm
- aspect ratio 4:3 (2056 x 1542 px)
- Full resolution with up to 57 fps
- Full HD with up to 80 fps
- global-shutter CMOS-sensor
- AOI
- Long-term exposure up to 30 seconds
- 12-bit per pixel

Mounts:

Mounting options:

- direct
- with mounting brackets (accessories)

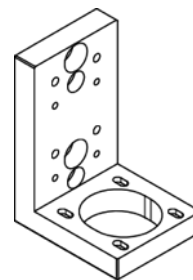

IM-ZM-00007

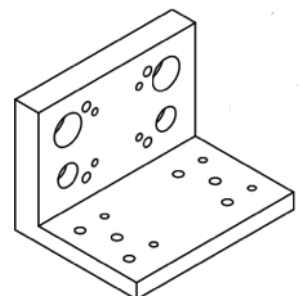

IM-ZM-00013