

MV-CH290-60GM-F-NF 29MP, 36mm×24mm CCD, GigE Camera

GigE
VISION



The Hikvision MV-CH290-60GM-F-NF 29 MP 36mm×24mm CCD GigE Camera is a high quality device that can be used in a variety of applications, including SMT automatic optical detection, PCB AOI, FPD detection, railway related applications and etc.

Key Features

- 29 MP resolution, pixel size of 5.5μm
- High quality CCD sensor with ultra high signal-to-noise ratio, wide dynamic range, excellent imaging quality
- 128 MB on-board buffer, which enable to cache multiple pictures for data transmission or image retransmitting in Burst mode
- GigE interface, with the maximum transmission distance of 100 m (without relay)
- Support serial port communication, communication protocol RS232 or full-duplex RS485
- Compact construction design with mounting holes on the up and bottom panels for flexible mounting

Application Scenarios

- SMT automatic optical detection
- PCB AOI
- FPD detection
- Railway related applications

Spectral Response

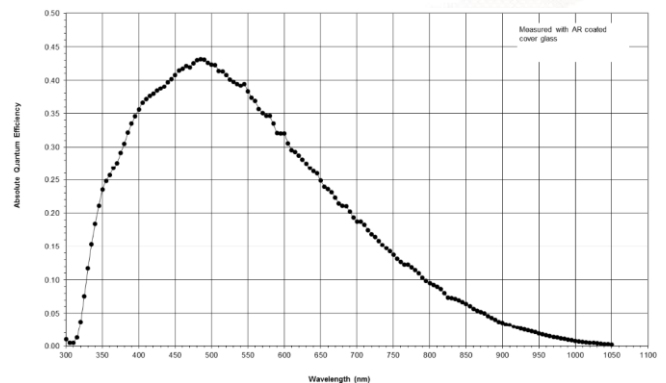

MV-CH290-60GM-F-NF Quantum Efficiency

Order Model

Mono: MV-CH290-60GM-F-NF



Specifications

Parameters	Model	MV-CH290-60GM-F-NF
	29MP, 36mm×24mm CCD, GigE Camera	
Camera		
Sensor	KAI29050	
Pixel Size	5.5μm×5.5μm	
Sensor Size	36mm×24mm	
Resolution	6576×4384	
Frame Rate	4fps	
Dynamic Range	>64dB	
SNR	>40dB	
Gain Range	0-20dB	
Exposure Time	110μs-1sec	
Shutter Mode	Global Shutter. Auto-Exposure, Manual Exposure, One-key Exposure	
Data Interface	Gigabit Ethernet	
General Purpose I/O	12 pin IO, Opto-isolated input x1, Opto-isolated output x1, Bi-directional non-isolated I/O x1, RS232 x1, full-duplex RS485 x1	
Image Buffer	128MB	
Data Format	Mono 8/10/10p/12/12p	
General		
Power	Approx. 12W@12VDC, Voltage 12VDC	
Temperature	Working Temperature 0~50℃, Storage Temperature -30~70℃	
Dimension	74mm×74mm×84.88mm	
Weight	Approx. 552g	
Lens Interface	F-mount, optical focal back length 46.5 mm	
Software	MVS or Third-Party Software supporting GigE Vision Protocol	
Operating System	Windows XP/7/10 32/64bits	
Compliance	GigE Vision	
Certification	CE, FCC, RoHS	

Recommended Accessories

- **Power:** 12VDC @2A power adapter
- **NIC:** Intel Pro1000 and above version recommended
- **Network Cable:** CAT5e or CAT6 network cable recommended

Dimensions

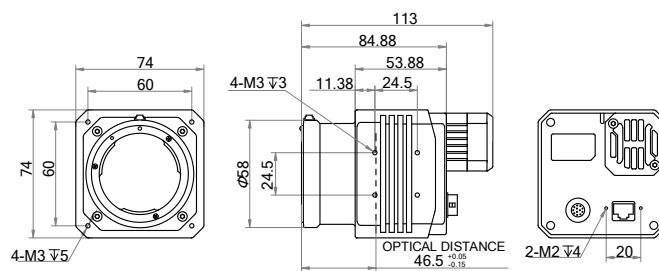

MaxxVision®

Sigmaringer Str. 121
70567 Stuttgart
Tel.: 0711 997 996 3
www.maxxvision.com