

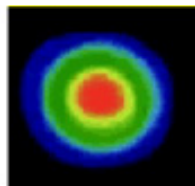

MQU Series Solid-State Lasers

Far field



Near field

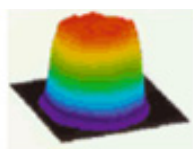

MQU FEATURES & BENEFITS

- ◆ Can be injection seeded for narrow bandwidth allowing pumping source for OPO, Ti:sapphire, dye laser, or for high resolution experiments
- ◆ Laser head can be readily removed for lamp changes and replaced without realignment
- ◆ Incorporates Gaussian optics pioneered by Zklaser® to provide high spatial uniformity in the beam
- ◆ Compact, sealed and rugged designed for maintain free

System Specifications	MQU-200	MQU-500	MQU-1000	MQU-2000	MQU-10000
Repetition Rate	30Hz	20Hz	10Hz	10Hz	1Hz
Energy					
1064nm	200mJ	500mJ	1000mJ	2000mJ	10J
532nm(optional)	120mJ	300mJ	600mJ	1200mJ	6J
355nm (optional)	30mJ	80mJ	200mJ	400mJ	2J
266nm (optional)	10mJ	30mJ	100mJ	150mJ	800mJ
Pulsewidth ¹ (FWHM)					
1064nm	8-10ns	8-10ns	8-10ns	8-10ns	8-10ns
532nm	5-8ns	5-8ns	5-8ns	5-8ns	5-8ns
355nm	3-7ns	3-7ns	3-7ns	3-7ns	3-7ns
266nm	3-6ns	3-6ns	3-6ns	3-6ns	3-6ns
Energy Stability					
1064nm	±2%	±2%	±2%	±2%	±2%
532nm	±3%	±3%	±3%	±3%	±3%
355nm	±4%	±4%	±4%	±4%	±4%
266nm	±5%	±5%	±5%	±5%	±5%
Beam Diameter ² (1/e ²)	7mm	8mm	9mm	12mm	18mm
Divergence (1/e ²)	<1mrad	<1mrad	<1mrad	<1mrad	<1mrad
Beam Pointing Stability ³	±30 μrad	±30 μrad	±30 μrad	±30 μrad	±30 μrad
Warm up time ⁴	<5min	<5min	<5min	<5min	<5min
Jitter ⁵					
Unseeded	±2ns	±2ns	±2ns	±2ns	±2ns
Seeded	±0.5ns	±0.5ns	±0.5ns	±0.5ns	±0.5ns
Linewidth ⁶					
Standard	1cm ⁻¹	1cm ⁻¹	1cm ⁻¹	1cm ⁻¹	1cm ⁻¹
Injection Seeded,SLM	0.003cm ⁻¹	0.003cm ⁻¹	0.003cm ⁻¹	0.003cm ⁻¹	0.003cm ⁻¹

NOTES

1. FWHM full width half max
2. Full Diameter for 86% (1/e²)
3. 99.9% shots will be <±30 μrads with ΔT room<±3° C
4. Time to reach full energy
5. With respect to external trigger
6. FWHM (1cm⁻¹=30 GHz)

All specifications at 1064 nm unless otherwise noted.
As a part of our continuous improvement program, all specifications are subject to change without notice.



MQU Series Solid-State Lasers are the no compromise laser source for applications where energy and beam quality are required. The MQU series is the ideal pump source for OPO's, Ti:sapphire, CPA, OPCPA or dye laser . The Gaussian mirror coupled resonator is optimally mode filled for maximum energy extraction allowing amplification to >10 J / pulse. The Gaussian mirror coupled resonator can be injection seeded for narrow bandwidth.

Specifications

Utility and Environmental、Service Requirements	Power supply Power Consumption Room temperature	220 or 240 VAC, single Phase, 4 to 20 A 500 to 4000W 10 to 40° C
Water	Service Temperature	1-3 GPM (gallons / minute) at 10 - 40 PSI pressure drop Temperature control precision less than 0.1° C
Dimensions(L×W×H)	Laser size Power Supply size	676×200×130mm 462×560×700mm
Weights	Laser Head Power Supply	12Kg 25Kg
Umbilical Length		3.5 m

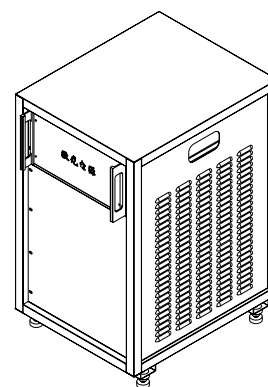
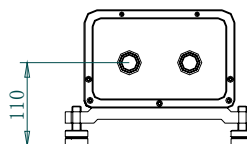
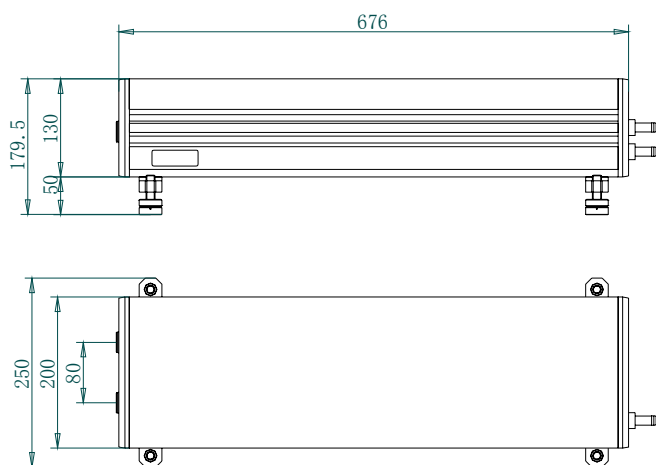

ZK LASER®

All Dimensions are in mm

Beijing ZK Laser Co., Ltd

Address: 26 Dongbeiwang South Road, Haidian District, Beijing, China
Tel: +86-10-62964766
Fax: +86-10-62974734
E-mail: webmaster@zklaser.com
Web: www.zklaser.com

ZK Laser follows a policy of continuous product improvement. Specifications are subject to change without notice.

ZK Laser offers a limited warranty for all MQU™ systems. For full details on warranty coverage, please refer to the Service and Support section at www.zklaser.com, or contact your local Sales or Service Representative.

