

DSS 1064-3000

Diode pumped passively Q-switched solid state laser

- 1064 nm
- single pulse
- < 2.5 ns
- 1 – 80 Hz
- > 2500 µJ



biology · biomedicine · chemistry · analytics

Optical Data	Wavelength	1064 nm
	Spatial Mode	TEM ₀₀
	Beam Divergence (full angle)	< 9 mrad
	Beam Ellipticity	< 2:1
	Waist Diameter	600 ± 150 µm (located at about 110mm inside the laser head)
	Beam Diameter	1200 ± 400 µm (at laser exit)
	Peak Power	> 1250 kW @ 20 Hz
	Pulse Energy	> 2500 µJ @ 20 Hz
	Pulse Repetition Rate (with external trigger)	1 - 80 Hz
	Pulse Width (FWHM)	< 2.5 ns
	Polarization Ratio	> 50:1, vertical
	Long term pulse energy stability (6 hrs)	< ± 8 %
Laser Classification	3B / IIIb	
Optical Output	Free Beam	
Electrical Data	Electrical Power Consumption	< 100 W (@230V AC)
	Line Voltage	90 - 265 V AC (50-60 Hz) or 24 V DC
Interface	RS 232 (USB on request)	
Miscellaneous	Warm-up Time	< 10 min
	Operating Temperature	28 - 35 °C
	Laser Head Size	217 x 65 x 45 mm (core dimensions)
Options	SMA-connector for fibers with core diameter ≥ 600 µm	
	Synchronization signal output (rise time < 2 ns)	
	Manual shutter or electrical beam blocker	
	Manual or electrical attenuator	
	Stand alone system (CDRH compliant; incl. key switch, heat sink, manual beam shutter)	

Laser Head and Controller

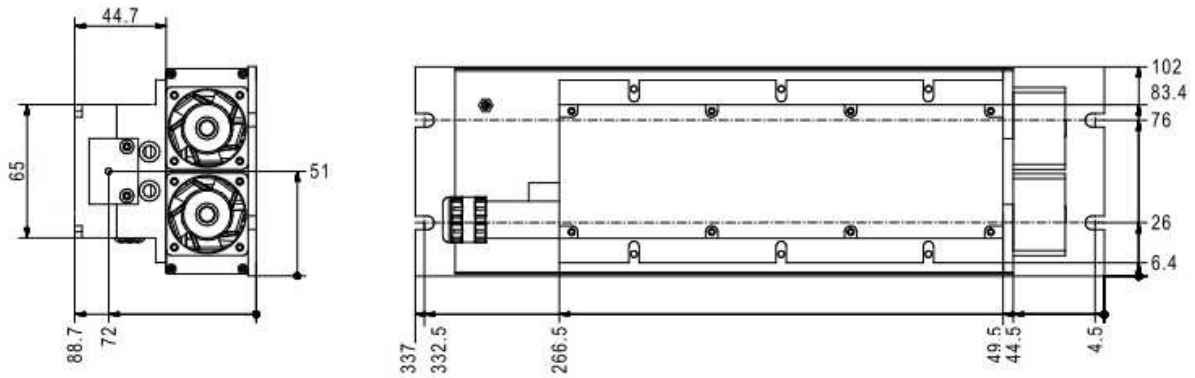

OEM booster and controller

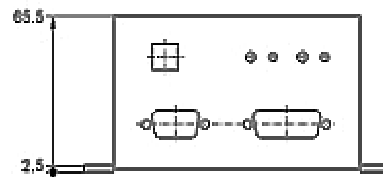
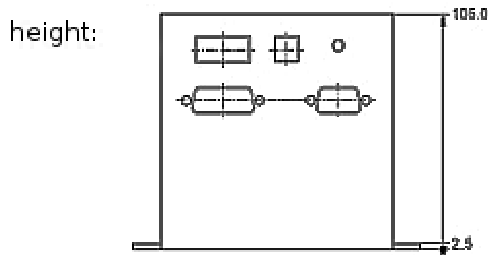

length:

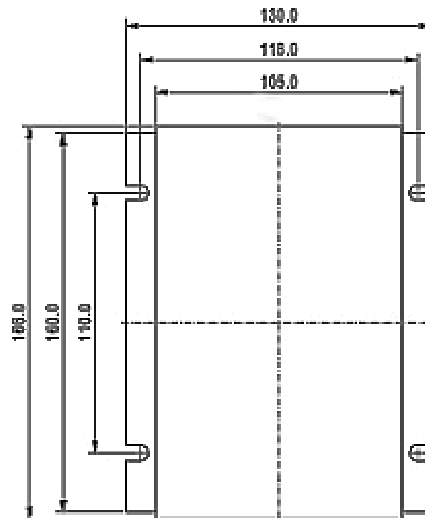

Laser Safety Labels

The DSS1064-3000 lasers are class 3B according to IEC 60825-1:2007

