

### Product Features

- Wide Dynamic range to 120dB provides brilliant color detail within both shadows and brightest light scenes
- Miniature rugged 30.5mm x 27.5mm housing
- Preset for ATM Outdoor/ Indoor Environments
- Low 0.1 lux sensitivity
- M-12 and pinhole lens mount options
- Threaded top, bottom and side mounting holes

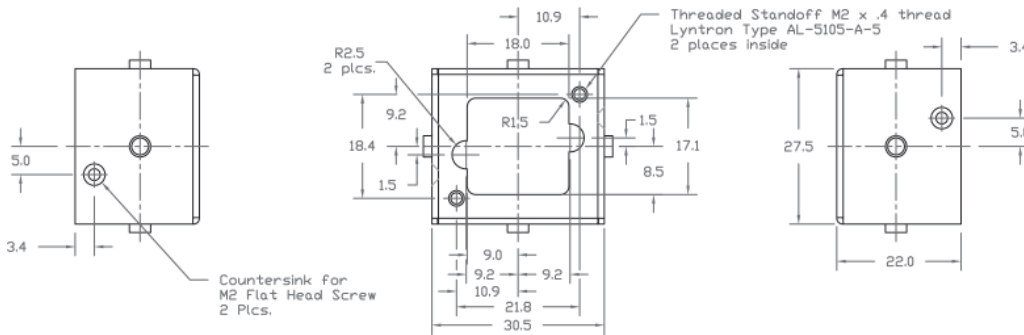

Shown with optional lens



#### J100 Connector (I<sup>2</sup>C)

01 VIN	05 I2C-SCL
02 GND	06 I2C-SDA
03 VIDEO	07 GND
04 DO NOT USE	08 OSDC

#### J101 Connector (Digital)

01 GND	11 YUV4	21 IRIS OUT (analog)
02 GND	12	22 GND
03 YUV0	13 YUV5	23 HSYNC
04	14	24 VSYNC
05 YUV1	15 YUV6	25
06	16	26
07 YUV2	17 YUV7	27 I2C-SDA
08	18	28 I2C-SCL
09 YUV3	19 CLOCK	29 CVBS OUT (analog)
10	20	30 POWER IN

### Technical Specifications

Electrical	20C715W	21C715W
	NTSC	PAL
Image Sensor	1/3" CMOS	
Effective Pixels (H x V)	756 x 504	
Pixel Size	6.35um x 7um	
Shutter Mode	Rolling	
Horizontal Resolution	690 TVL	
Aspect Ratio	4:3	
Sensitivity	<0.1 Lux color / <0.01 Lux B&W	
White Balance Range	2,000K - 11,000K	
Wide Dynamic Range	120dB (max), 102dB (typical)	
Synchronization	Internal	
Iris	Manual	
Video Output	CVBS / BT656	
Signal to Noise Ratio	50dB	
Supply Voltage	5VDC – 12VDC +/- 10%	
Power Consumption	<0.8W	

#### Viewer Software Controls (Future)

Scanning System	2:1 Interlace default
Frame Rate	30fps
White Balance Control	AWB (default)
Day & Night	Auto (default)
Communication	I <sup>2</sup> C
Image Flip	Default off
Mirror Mode	Default off
AGC Control	Auto (default)

#### Environmental

Operating Temperature	-10°C ~ 50°C (14°F ~ 122°F)
Operating Humidity	30% - 90%
Storage Temperature	-30°C ~ 80°C (-22°F ~ 176°F)
Storage Humidity	<85%RH

#### Mechanical

Dimensions WxHxD	30.5mm x 27.5mm x 22mm (1.2" x 1.08" x 0.86") without M-12 lens mount
Weight	23.5g (0.83 oz) with M-12 mount
Lens Mount	M-12 Board
Lens	See our lenses at <a href="http://www.videologyinc.com/lenses">www.videologyinc.com/lenses</a>

#### Connectors

J100	70CN0080	JST-BM08B-SRSS-TB	CONN JST 8 PIN TOP ENTRY SMD
J101	70CN0303	JST-30P4.0-JMCS-G-TF	CONN JST 30 PIN 4MM STACK HEIGHT JMC BD-BD TOP ENTRY

#### Accessories

Included	60C1041	8pin JST cable with flying leads
----------	---------	----------------------------------

#### I<sup>2</sup>C Communication Kit (Optional)

60C2-U	I <sup>2</sup> C board, program cable, USB cable, camera control software (SFT-14521)
--------	---

#### OSD Kit (Optional)

60C2-O	72V0281	OSD control board
Kit Includes	60C0510	USB cable