

### Product Features

Provides analog (CBVS) and USB (2.0) video output **simultaneously**

- 1/3" CMOS sensor
- Dynamic range to 120dB provides brilliant color detail within both shadows and brightest light scenes
- Miniature rugged 22mm x 26mm double board
- Low 0.1 lux sensitivity
- Metal CS, M-12 and pinhole lens mounts
- Optional mini metal housings suitable for ATMs and Kiosks
- Day/Night
- Digital zoom (via OSD or I<sup>2</sup>C option)



Shown with optional lens

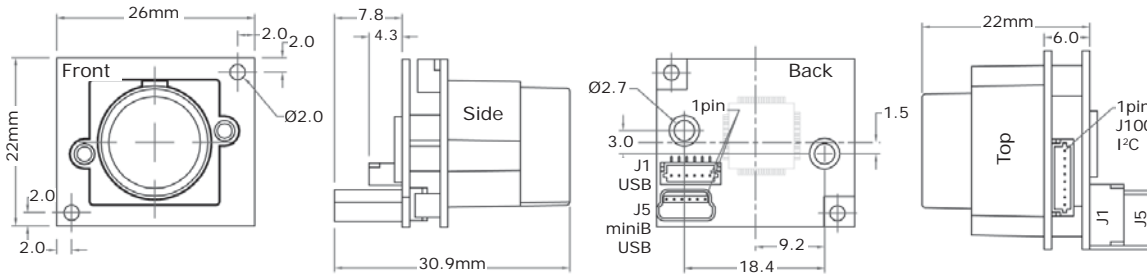

#### J100 Connector (I<sup>2</sup>C, Analog)

01 OSDC	05 DO NOT USE
02 GND	06 VIDEO
03 I2C-SDA	07 GND
04 I2C-SCL	08 VIN

#### J1 JST Connector (USB)

01 +5VDC	04 ID
02 DATA -	05 GND
03 DATA +	06 GND

#### J5 miniB USB Connector

01 +5VDC	04 ID
02 DATA -	05 GND
03 DATA +	

### Technical Specifications

Electrical	20C21XWUSB	21C21XWUSB
	NTSC	PAL
Image Sensor	1/3" CMOS	
Effective Pixels (H x V)	756 x 504	
Pixel Size	6.35um x 7.4um	
Shutter Mode	Rolling	
Aspect Ratio	4:3	
Sensitivity	<0.1 Lux color / <0.01 Lux B&W	
White Balance Range	2,850K - 6,000K	
Wide Dynamic Range	120dB (max), 102dB (typical)	
Synchronization	Internal	
Gamma	.45 Default	
Communication	I <sup>2</sup> C	
Signal to Noise Ratio	47.9dB	
Scanning System	2:1 Interlace default / Progressive (Optional)	
Iris	Manual	
Video Output	USB 2.0 and CVBS	
Supply Voltage	5VDC via USB bus	
Power Consumption	<1.0W	
Motion Stabilization	Default OFF	

#### Viewer Software Controls

Back Light Compensation	Default ON
White Balance Control	AWB (Default)
Day & Night	Auto (Default)
Image Flip	Default OFF
Mirror Mode	Default OFF
AGC Control	Auto (Default)

#### Environmental

Operating Temperature	-10° ~ 50° Celsius (14°F ~ 122°F)
Operating Humidity	30% - 90%
Storage Temperature	-30°C ~ 80°C (-22°F ~ 176°F)
Storage Humidity	<85%RH
MTBF	150,000 hours

### Mechanical

Dimensions WxHxD	26mm x 22mm x 30.9mm (1" x 0.86" x 1.2") with M-12 lens mount		
Weight	17g (0.6oz) (with M-12 mount)		
Lens Mounts	Replace "X" in model number with desired lens mount		
Ex: Change 20C21XUSB to 20C215USB to select an M-12 Board Mount	2 = M-12 Pinhole	5 = M-12 Board	8 = CS
Lens	See our lenses at <a href="http://www.videologyinc.com/lenses">www.videologyinc.com/lenses</a>		

### Software

Viewer (included) SFT-07019	<ul style="list-style-type: none"> <li>• WDM device drivers</li> <li>• DirectX/DirectShow compliant</li> <li>• TWAIN compliant (requires driver installation)</li> </ul>
SDK (optional) SFT-07019-SDK	Complete software development kit and support for OEMs

#### Recommended System Requirements

Hardware	Pentium IV	2.3GHz +, 1GB hard drive, Intel USB 2.0 Host controller
Software	Windows 7, 8, 10	32 bit and 64 bit
	Vista	32 bit and 64 bit
	XP	Service pack 2 +, DirectX 9.0c or above

### Accessories

Optional USB 2.0 Cables	60C1147	10ft (3.048m) USB mini (B) to USB (A)
	60C1062	8ft (2.4384m) 6-pin JST to USB (A)
Other cable length options are available. Please contact a Videology Sales Rep. for details		

### I<sup>2</sup>C Communication Kit (Optional)

60C2-U	I <sup>2</sup> C board, program cable, USB cable, camera control software (SFT-14521)	
--------	---	--

### OSD Kit (Optional)

60C2-O	72V0281	OSD control board
Kit Includes	60C1050	USB cable