

# 1030nm Polarization Maintaining Optical Isolator

## PERFORMANCE SPECIFICATIONS

Parameter	Specifications
Operation Wavelength	1020nm to 1040nm
Typical Peak Isolation	25dB
Minimum Isolation	20dB
Typical Insertion Loss	0.8dB
Maximum Insertion Loss	1.2dB
Extinction Ratio	20dB(Typ. 25dB)
PMD	0.2ps
Return Loss	≥ 50dB
Optical Power	600mW
Operating Temperature	0 to + 60°C
Storage Temperature	-40 to +85°C
Fiber Type	See Order Information
Package Dimensions	L52mm x W28mm x H27mm

## FEATURES

High Isolation  
Low Insertion Loss  
High Extinction Ratio  
High Stability and Reliability  
Cost Effective

## APPLICATION

Fiberoptic Amplifiers  
Pump Laser Source  
Fiberoptic Sensor  
Test and Measurement  
Instrumentation

Note:

1. The PM fiber and the connector key are aligned to the slow axis.
2. The ER is for fiber  $\leq 0.75$  meter. Increase fiber length can decrease the ER.
3. For devices with connectors, insertion loss will be 0.3dB higher, return loss will be 5dB lower, and extinction loss will be 2dB lower.

## MECHANICAL DIMENSIONS

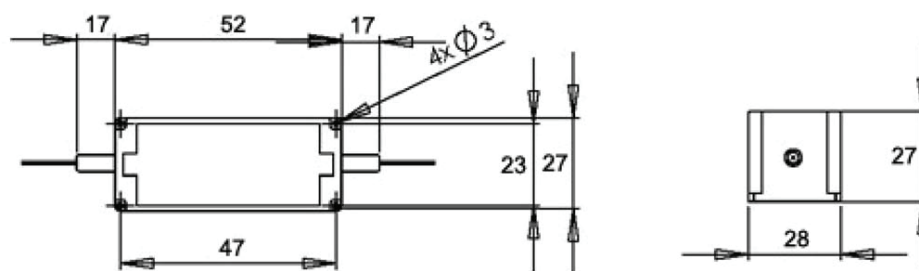

## ORDERING INFORMATION

PMIS						
Wavelength	Grade	Pigtail Style	Fiber Length	Fiber Type	In/Out Connector	Working axis
1030 = 1030nm	P = Grade P	1 = Bare Fiber 2 = 900um Jacket	1 = 0.25m 2 = 0.5m 3 = 1.0m 4 = Custom Length	2 = PM980 S = Special	0 = None 1 = FC/APC 2 = FC/PC 3 = SC/APC 4 = SC/PC 5 = ST 6 = LC/UPC 7 = LC/APC X=Special	S = Slow axis working B = Both axes working F = Fast axis working